

# GS-1.5

## COUNTERTOP COOLER

G-SERIES

### FEATURES

- **Exterior Dimensions (WDH):** 14.5" x 15.875" x 21.5"
- **Internal Volume:** 0.96 ft<sup>3</sup>
- **Footprint:** 1.6 sq. ft.
- Dynamic LED Lighting In Door Provides Enhanced Product Illumination While Greatly Reducing Energy Consumption
- Forced Air Refrigeration System For Fast Product Temperature Pull Down
- Optional Side Decals for Branding Awareness
- High Density Environmentally Friendly Insulation
- Climate-Friendly Natural Refrigerant
- 1 Fixed Powder-Coated Metal Shelf
- Double-Paned, Low "E", Self-Closing Glass Door
- Durable Pre-Painted, Chip Resistant, Steel Cabinet
- Heavy-Duty, NSF Approved, Interior Liner
- NSF Approved Interior Analog Thermometer Allows Packaged Perishable Foods to be Merchandised Safely
- Adjustable Temperature Control
- 9' Heavy Duty Power Cord



High Visibility  
Animated LED  
Illuminated Logo in  
Door. Not certified  
for 220V

### CERTIFICATIONS

110-120V/60Hz



- UL471
- NSF/ANSI-7: Type 2 Display Refrigerator
- ENERGY STAR® Qualified



The specifications contained herein are for illustrative marketing purposes only and are not intended to be relied upon in whole or in part. All creative works are the sole property of IDW, Inc. Any reproduction in part or as a whole without written permission from IDW, Inc. is prohibited.

# GS-1.5

## COUNTERTOP COOLER

### TECH SPECS

Refrigerant	R600a
Amps	2
Volts/Hz	110-120V/60Hz
Compressor HP	1/8

### DIMENSIONS

Exterior (WDH)	14.5" x 15.875" x 21.5"
Interior (WDH)	11.375" x 9.5" x 16.875"
Shelf (WD)	10.875" x 8.25"
Internal Volume	0.96 ft <sup>3</sup>



### SHIPPING SPECS

Gross Weight	57 lbs
Net Weight	53 lbs
Carton Dims (WDH)	16.5" x 18.5" x 22.5"
Units per Pallet	18
Shipping Options (Floor Loaded)	20' ~240 40'HQ ~500 53' ~468

#### EXTERIOR DIMENSIONS

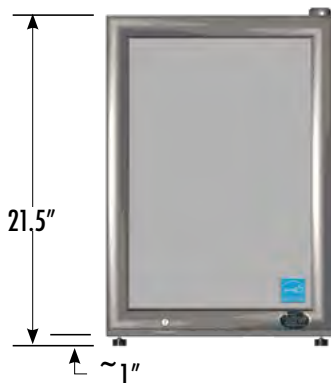

#### INTERIOR DIMENSIONS

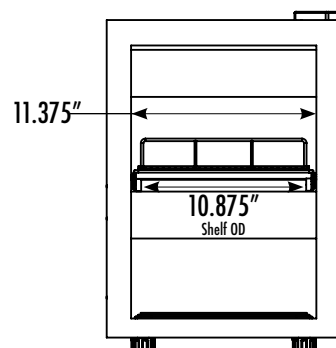

### PACKOUT CAPACITIES

		Facings	Deep	Total Capacity	Total Rows
	1 Shelf	4	x 3	= 20	2
	Base	4	x 2		
	1 Shelf	4	x 3	= 20	2
	Base	4	x 2		

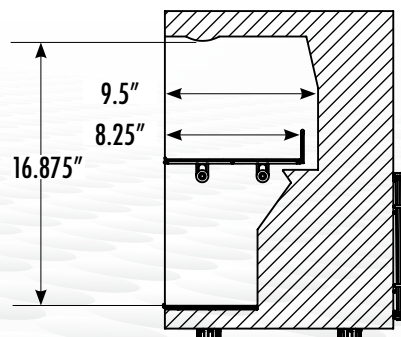
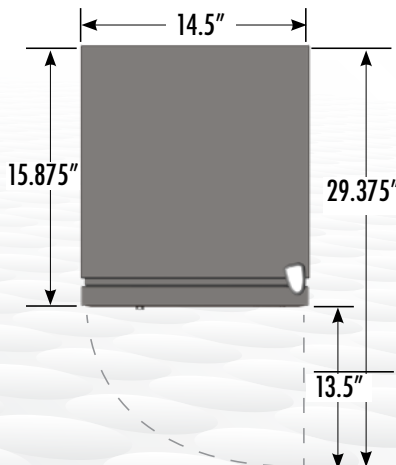

The specifications contained herein are for illustrative marketing purposes only and are not intended to be relied upon in whole or in part. All creative works are the sole property of IDW, Inc. Any reproduction in part or as a whole without written permission from IDW, Inc. is prohibited.

8825 Boston Place, Rancho Cucamonga CA 91730 Toll: 877.307.2665 | Office: 909.447.8254 | Fax: 909.305.8756

Last Updated: August 17, 2021 11:10 AM