

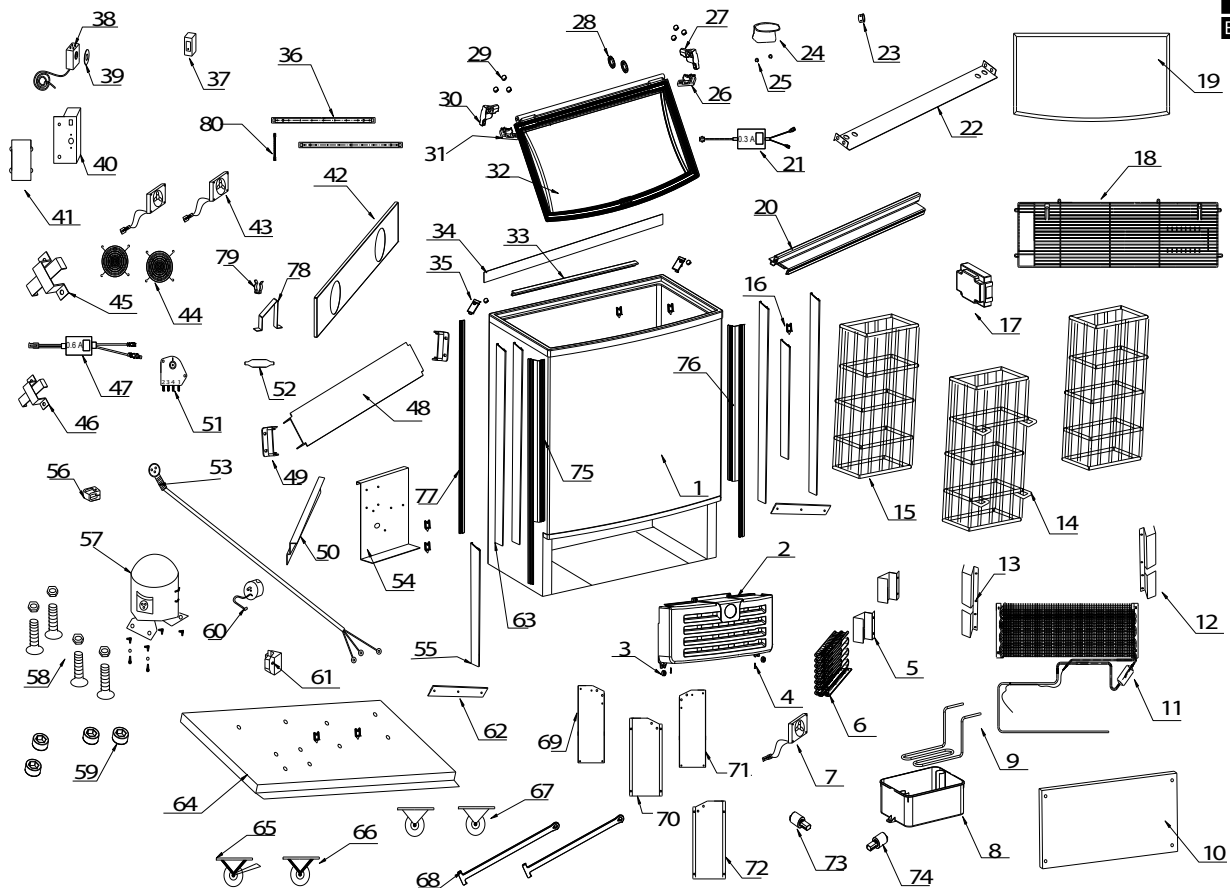

PARTS & IDENTIFICATION



- | | | | | |
|-----------------------------|--------------------------------|--------------------------------|-------------------------------|------------------------------------|
| 1. Main Cabinet | 18. Rear Grill | 35. Side Graphic Holder | 52. Filter Dryer | 69. Tension Rod Box (Bottom Left) |
| 2. Front Grill | 19. Lid Gasket | 36. LED Light (2) | 53. Power Cord | 70. Tension Rod Box (Top Left) |
| 3. Front Grill Bracket (2) | 20. Plastic Graphic Frame | 37. Light Switch | 54. Electrical Board | 71. Tension Rod Box (Bottom Right) |
| 4. Self-Tapping Screw (2) | 21. Inner Light Transformer | 38. Thermostat | 55. Trim Piece (Top Left) (2) | 72. Tension Rod Box (Top Right) |
| 5. Electrical Wire Tray (2) | 22. Inner Fan Baffle Bracket | 39. Thermostat Indicator | 56. Plastic Clip | 73. Damper (Left) |
| 6. Condenser | 23. Wire Sleeve | 40. Thermostat Box | 57. Compressor | 74. Damper (Right) |
| 7. Condenser Fan | 24. Handle | 41. Thermostat Box Cover | 58. Leveling Leg (4) | 75. Trim Piece (Bottom Left) |
| 8. Drip Pan | 25. Spring Washer (2) | 42. Inner Fan Baffle | 59. Leveling Leg Sleeve (4) | 76. Trim Piece (Bottom Right) |
| 9. Hot Gas Line | 26. Hinge Cover (Bottom Right) | 43. Evaporator Fan | 60. Overload Breaker | 77. Trim Piece (Bottom Back) (2) |
| 10. Evaporator Baffle | 27. Hinge Cover (Top Right) | 44. Fan Grill (2) | 61. Start Relay | 78. Filter Dryer Bracket |
| 11. Evaporator | 28. Hinge Gasket (2) | 45. Transformer Box | 62. Graphic Frame (Top) (2) | 79. Filter Dryer Clip |
| 12. Bracket Baffle (Right) | 29. Hinge Cover (8) | 46. Transformer Box | 63. Trim Piece (Top Back) (4) | 80. LED Panel Wires |
| 13. Bracket Baffle (Left) | 30. Hinge Cover (Top Left) | 47. Transformer | 64. Compressor Panel | |
| 14. Bracket Baffle (Right) | 31. Hinge Cover (Bottom Left) | 48. LED Light Cover | 65. Swivel Locking Caster | |
| 15. Basket (Side) (2) | 32. Lid | 49. LED Light Cover Holder (2) | 66. Swivel Caster | |
| 16. Basket Clip (7) | 33. Graphic Holder (back) | 50. Wire Tray Bracket | 67. Directional Caster(2) | |
| 17. Junction Box Set | 34. Canopy Board | 51. Defrost Timer | 68. Tension Rod(2) | |

