

# PARTS & IDENTIFICATION

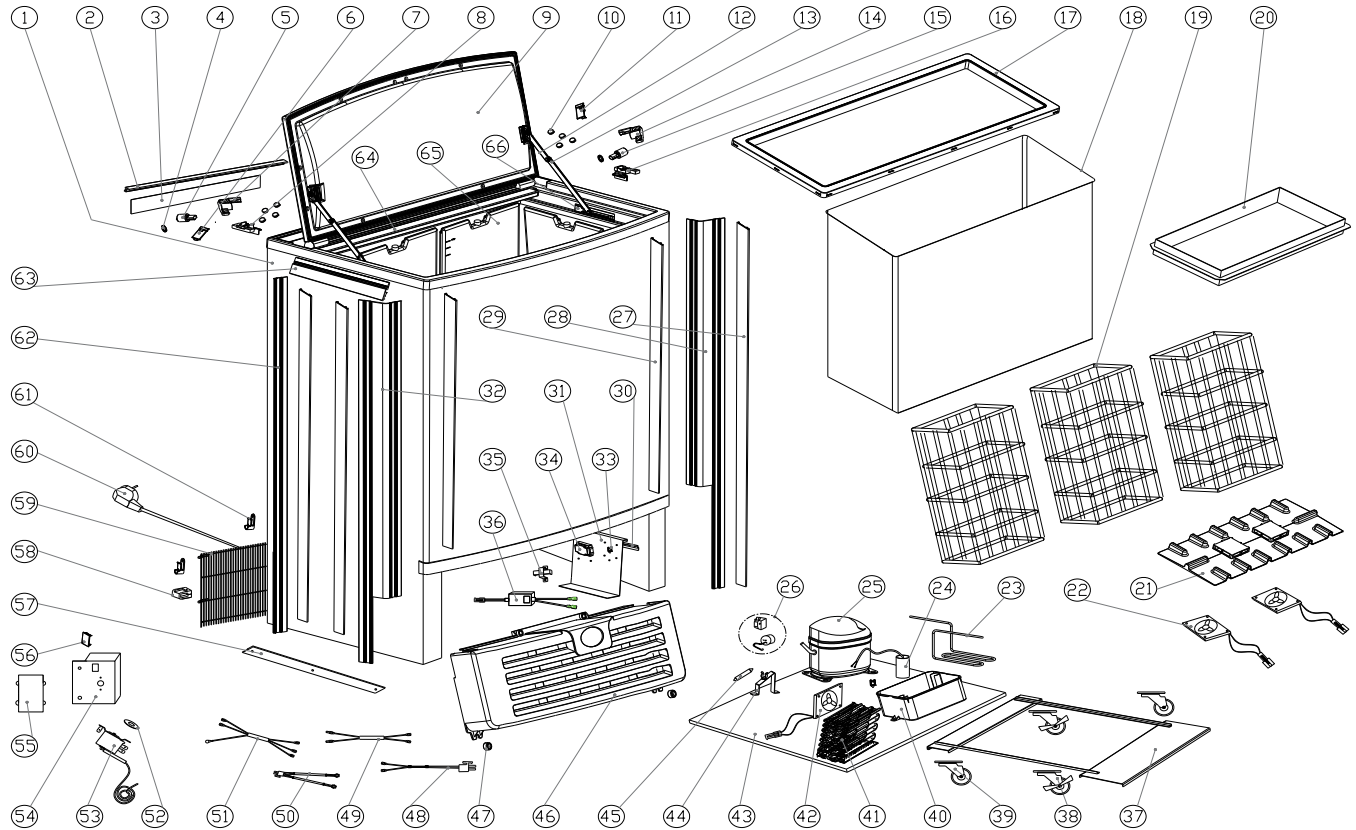

- |                               |                               |                              |                                  |                    |
|-------------------------------|-------------------------------|------------------------------|----------------------------------|--------------------|
| 1. Foam Cabinet               | 17. Rim                       | 33. Wire clip (7)            | 49. Compressor Connecting Wire   | 65. Ice Pack (12)  |
| 2. Graphic Holder (back)(2)   | 18. Inner Liner               | 34. Junction box             | 50. Inner fan Connecting Wire    | 66. Guide Rail (2) |
| 3. Canopy Board               | 19. Basket (3)                | 35. Transformer Box          | 51. Thermostat Connecting Wire   |                    |
| 4. Hinge Gasket(2)            | 20. Coolant Box Holder (2)    | 36. Transformer (0.6A)       | 52. Thermostat Label             |                    |
| 5. Damper (left)              | 21. Inner Fan Baffle          | 37. Castor Installation Base | 53. Thermostat                   |                    |
| 6. Canopy Plate               | 22. Evaporator Fan (2)        | 38. Locking Caster (2)       | 54. Thermostat Box               |                    |
| 7. Dampener Box left upper    | 23. Condensate Coil           | 39. Caster (2)               | 55. Thermostat Box Cover         |                    |
| 8. Dampener Box left bottom   | 24. Capacitor                 | 40. Drip Pan                 | 56. Hole Cover Switch            |                    |
| 9. Door Lid Assembly          | 25. Compressor                | 41. Condenser                | 57. Trim Piece (bottom) (2)      |                    |
| 10. Hinge Cover (8)           | 26. Compressor Accessories    | 42. Condenser Fan            | 58. Plastic Clip                 |                    |
| 11. Canopy Plate (right)      | 27. Trim Piece (top back) (4) | 43. Compressor Base          | 59. Rear Compartment Grill       |                    |
| 12. Tension Rod (top)(2)      | 28. Trim Piece (bottom right) | 44. Filter Drier Bracket     | 60. Power Cord                   |                    |
| 13. Tension Rod (bottom)(2)   | 29. Trim Piece (top left) (2) | 45. Filter Drier             | 61. Power Cord Holder (2)        |                    |
| 14. Dampener Box right upper  | 30. Wire Tray Bracket         | 46. Front Grill              | 62. Trim Piece (bottom back) (2) |                    |
| 15. Dampener right            | 31. Electrical Board          | 47. Front Grill Bracket (2)  | 63. Side Graphic Holder (2)      |                    |
| 16. Dampener Box right bottom | 32. Trim Piece (bottom left)  | 48. Fan Connecting Wire      | 64. Plastic Graphic Frame        |                    |